

DOVETAIL FEATURES
USED TO
INTERLOCK MULTIPLE HOLDERS

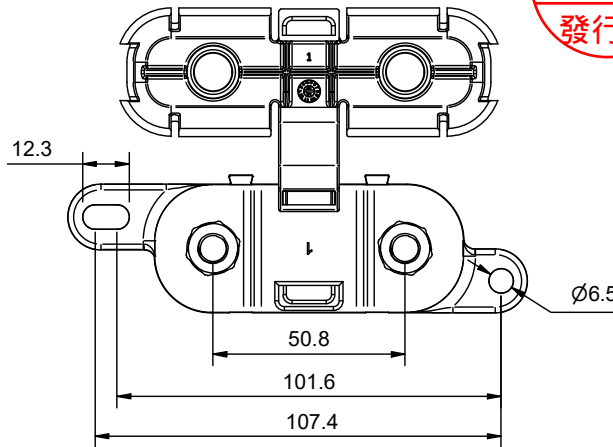

M8X1.25 (2X)
(HEX NUT &
SPLIT WASHER SHOWN)

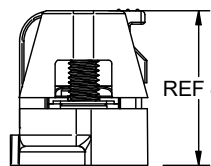
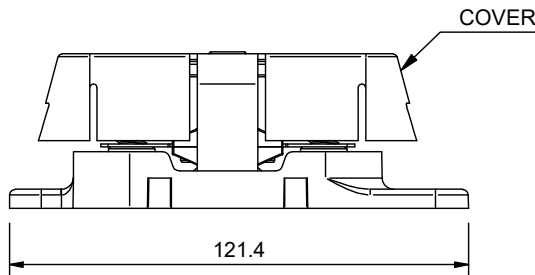
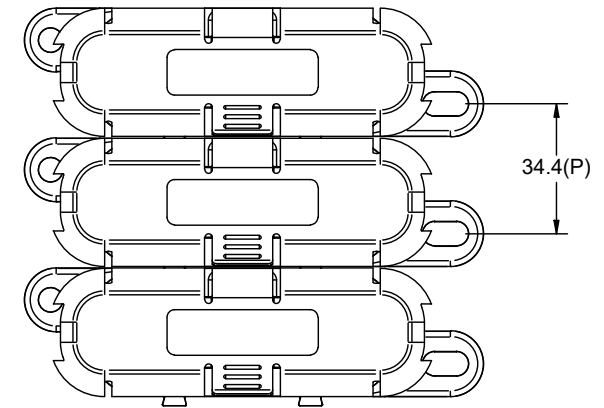
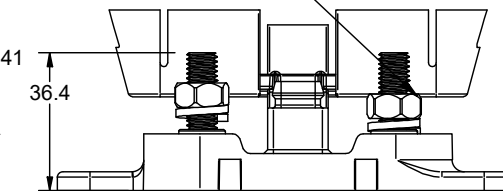

Shown interlocked

Applications:

- Compatible with HFM high-current bolt-down fuses up to 500 amps (sold separately unless indicated)
- Dovetail feature lets you connect multiple HFM Flex Series fuse holders together to create a fused high-power distribution block (busbars for multi-fuse applications are sold separately)
- Slots molded into the base enable secure tie-wrap mounting
- Bolt-down fuse holder base features an M6 mounting hole and an M6 slot measuring 6mm long
- Options for stainless steel M8 studs and hardware help ensure long-term corrosion resistance

NOTES:

- 1.Recommended Fuses : For AFM(Fuse-link type SF 51) Series
- 2.Base : NY GF%, Black.
M8 Studs & Nuts & Split Washers: Stainless steel
- 3.Cover : Rubber , Black.
- 4.Max Fuse Rating : 500A
- 5.Max Voltage Rating: 70V DC/AC
- 6.Recommended Torque:
M8 Stud torque: 25 Nm Minimum
Mounting torque (using M6 bolts and washers):10 Nm Minimum
- 7.Temperature rating -40°C to 125°C.
- 8.Wire size : 8mm² to 30mm²

UNLESS OTHERWISE SPECIFIED DIMENSIONS ARE IN mm TOLERANCE (REF. ISO 2768 mK) DECIMALS ANGULAR >0.5~≤6±0.1 >6~≤30±0.2 >30~≤120±0.3 >120~≤400±0.5 DO NOT SCALE DRAWING THIRD ANGLE PROJECTION 		CUSTOMER NO.	JENN FENG ELECTRIC INDUSTRIAL CO., LTD. TITLE Bolt-Down Fuse Holder
		DRAWN BY Vivi	
		CHECKED BY	
P/N		APPROVED BY 林進有	PART NO. HFM
REV	B	DATE 2024/4/22	DRAWING NO. BA22111002
		SCALE	